

STRATTON 10

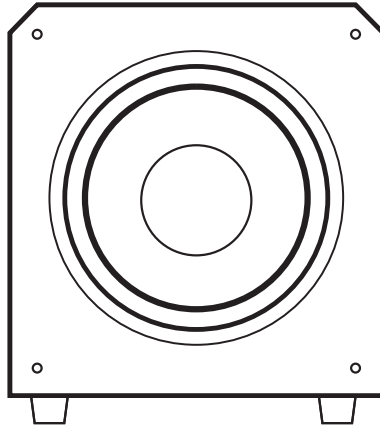

STRATTON 12

POWERED

SUBWOOFER

MANUAL

KLH[®]
LOVE YOUR MUSIC™



WELCOME!

Thank you for purchasing one of the best sounding powered subwoofers ever produced. At KLH, we have been making high-quality components since 1957, and we take pride in making your music and movies the best experience possible.

FOR YOUR SAFETY

Important Safety Instructions!

1. READ these instructions.
2. KEEP these instructions.
3. HEED all warnings.
4. FOLLOW all instructions.
5. DO NOT use this apparatus near water.
6. CLEAN with dry cloth.
7. DO NOT block any ventilation openings. Install in accordance with the manufacturer's instructions.
8. Do not install near any heat sources such as radiators, heat registers, stoves, or other apparatus (including amplifiers) that produce heat.
9. Protect the power cord from being walked on or pinched particularly at plugs, convenience receptacles, and the point where they exit from the apparatus.
10. Only use attachments/accessories specified by the manufacturer.
11. Unplug this apparatus during lightning storms or when unused for long periods of time.
12. Refer all servicing to qualified service personnel. Servicing is required when the apparatus has been damaged in any way, such as power-supply cord or plug is damaged, liquid has been spilled or objects have fallen into the apparatus, the apparatus has been exposed to rain or moisture, does not operate normally, or has been dropped.
13. DO NOT expose to excess moisture or liquids, and do not place containers with liquids on top of speakers.
14. The ventilation should not be impeded by covering the ventilation openings with items, such as newspapers, table-cloths, curtains, etc.
15. No naked flame sources, such as lighted candles, should be placed on the apparatus; the use of apparatus in moderate climates.
16. "WARNING", "To reduce the risk of fire or electric shock, do not expose this apparatus to rain or moisture."
17. MAINS plug or an appliance coupler is used as the disconnect device, the disconnect devices all remain readily operable;



The exclamation point, within an equilateral triangle, is intended to alert the user to the presence of important operating and maintenance (servicing) instructions in the literature accompanying the product.



The lightning flash with arrowhead symbol within an equilateral triangle is intended to alert the user to the presence of uninsulated "dangerous voltage" within the product's enclosure that may be of sufficient magnitude to constitute a risk of electrical shock to persons.



EU COMPLIANCE INFORMATION:

Eligible to bear the CE mark, Conforms to European Union EMC Directive 2004/108/EC; European Union Restriction of Hazardous Substances Recast (RoHS2) Directive 2011/65/EC; European Union WEEE Directive 2002/96/EC. KLH and the KLH logo are registered trademarks of Kelley Global Brands Inc., registered in the U.S. and other countries.

WEEE NOTICE

Note: This mark applies only to countries within the European Union (EU) and Norway.



This appliance is labeled in accordance with European Directive 2002/96/EC concerning waste electrical and electronic equipment (WEEE). This label indicates that this product should not be disposed of with household waste. It should be deposited at an appropriate facility to enable recovery and recycling.

BIENVENUE!

Nous vous remercions d'avoir acheté l'un des subwoofers les plus puissants jamais produits. Chez KLH, nous fabriquons des composants de haute qualité depuis 1957, et nous sommes fiers de faire de votre musique et de vos films la meilleure expérience possible.

POUR VOTRE SÉCURITÉ

Consignes de sécurité importantes!

1. Lisez ces instructions.
2. GARDEZ ces instructions.
3. HEED tous les avertissements.
4. SUIVEZ toutes les instructions.
5. N'utilisez PAS cet appareil près de l'eau.
6. NETTOYER avec un chiffon sec.
7. NE BLOQUEZ PAS les ouvertures de ventilation. Installez conformément aux instructions du fabricant.
8. Ne pas installer à proximité de sources de chaleur telles que des radiateurs, des bouches de chaleur, des poêles ou tout autre appareil (y compris les amplificateurs) produisant de la chaleur.
9. Protégez le cordon d'alimentation pour qu'il ne puisse pas marcher ou ne soit pas pincé, en particulier au niveau des prises, des accessoires et des points de sortie de l'appareil.
10. N'utilisez que des accessoires / accessoires spécifiés par le fabricant.
11. Débranchez cet appareil pendant les orages ou lorsqu'il n'est pas utilisé pendant de longues périodes.
12. Confiez toute réparation à un technicien qualifié. Un entretien est nécessaire lorsque l'appareil a été endommagé de quelque façon que ce soit, comme un cordon d'alimentation ou une prise endommagée, du liquide ou des objets sont tombés dans l'appareil, l'appareil a été exposé à la pluie ou à l'humidité, ne fonctionne pas normalement ou été abandonné.
13. NE PAS exposer à l'excès d'humidité ou de liquides et ne pas placer de récipients avec des liquides sur les haut-parleurs.
14. La ventilation ne doit pas être gênée en couvrant les ouvertures de ventilation avec des articles tels que des journaux, des nappes, des rideaux, etc.
15. Aucune source de flamme nue, telle que des bougies allumées, ne doit être placée sur l'appareil; l'utilisation d'appareils dans les climats modérés.
16. "AVERTISSEMENT", "Pour réduire le risque d'incendie ou d'électrocution, n'exposez pas cet appareil à la pluie ou à l'humidité."
17. La prise SECTEUR ou un coupleur d'appareil est utilisé comme dispositif de déconnexion, les dispositifs de déconnexion doivent rester facilement opérationnels;



Le point d'exclamation, dans un triangle équilatéral, est destiné à alerter l'utilisateur de la présence d'instructions importantes d'utilisation et de maintenance (entretien) dans la documentation accompagnant le produit.



Le symbole de l'éclair dans un triangle équilatéral est destiné à alerter l'utilisateur de la présence d'une «tension dangereuse» non isolée dans l'enceinte du produit qui peut être d'une amplitude suffisante pour constituer un risque de choc électrique pour les personnes.



INFORMATIONS DE CONFORMITÉ UE:

Éligible à porter la marque CE, conforme à l'EMC de l'Union européenne Directive 2004/108 / CE; Directive 2011/65 / CE de l'Union européenne sur la restriction de la refonte des substances dangereuses (RoHS2); Directive européenne DEEE 2002/96 / CE. KLH et le logo KLH sont des marques déposées de Kelley Global Brands Inc., enregistrées aux États-Unis et dans d'autres pays.

AVIS WEEE

Note: Cette marque s'applique uniquement aux pays de l'Union européenne (UE) et de la Norvège.



Cet appareil est étiqueté conformément aux normes européennes Directive 2002/96 / CE concernant les déchets électriques et équipement électronique (DEEE). Cette étiquette indique que ce produit ne doit pas être jeté avec les ordures ménagères. Il devrait être déposé dans une installation appropriée pour permettre la récupération et le recyclage.

UNPACKING

Place the package on the floor or table top with the box flaps up. Cut the tape with a utility knife to open the package. Fold the carton flaps back and carefully slide the subwoofer and packaging from the box, or turn the box over with flaps open and remove the box. Stand the subwoofer and packing upright, making sure the subwoofer is right side up, and remove the packing material.

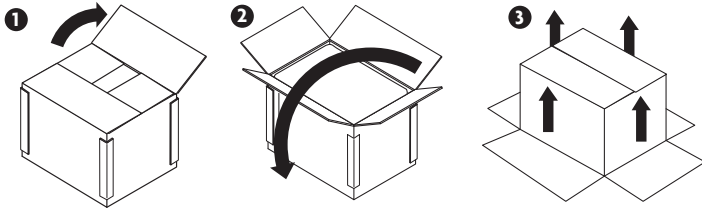

CONNECTION

Connect RCA connector from sub output on your amp/reciever to LINE input on subwoofer.



CROSSOVER

If you are using the Bass Management crossover menu settings in your A/V receiver or processor, select the 150Hz setting on the subwoofer, if you are not using this function, set to 80Hz.

CROSSOVER 80 **150**

VOLUME CONTROL

This control affects the output of your subwoofer, and should be set at lowest level before turning the power on. Volume can be increased until desired level is achieved. For 2-channel applications, you should adjust the volume to match the output of your speakers.



AC INPUT

Your subwoofer is supplied set to either 115 volts or 230 volts depending on the country it is shipped. This voltage can be changed by having a technician change the fuse (T3.15AL for 115 V and T1.5AL for 230V) and move the switch on your subwoofer amplifier to the desired voltage. Residents of some other countries will need to purchase an adapter or new proper power cord that fits your specific socket.

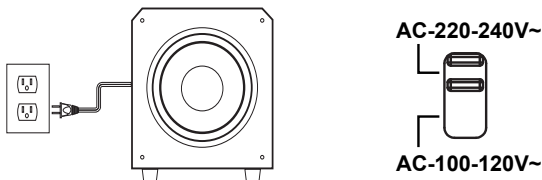

TRIGGER

Use of the trigger is an optional hook-up. If your A/V receiver or A/V preamp/processor has a 12-volt trigger output, you can run a 3.5mm connector cable to the subwoofer trigger input and your subwoofer will power on and off with your A/V receiver or A/V preamp-processor. When the trigger is in the "off" mode the LED will turn off and the amplifier will be switched to a low power consumption standby mode.

TRIGGER

0-180 PHASE CONTROL

This synchronizes the in/out movement of the subwoofer driver with the other speakers in your system. Once you have chosen the best location for your subwoofer, try flipping the phase switch between 0-180 to see which setting produces deeper and smoother bass output. Leave the switch at the setting that results in the smoothest and deepest bass at several listening locations in the room. If you hear no difference, leave the switch at the 0 position. Quite often this switch makes little difference, but it is dependent on your particular room dimensions and subwoofer location.

PHASE 0 **180**

POWER SWITCH

The POWER ON switch near the bottom of the panel supplies power to the sub amplifier. When this switch is in the ON position, the subwoofer will remain on, and the LED indicator will be illuminated.

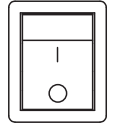

ROOM POSITION

The placement of your subwoofer can add a significant difference to the performance of your home theater system. Low frequencies are omnidirectional, but best performance results if you place the subwoofer in the corner, as this will increase the level of bass output. You can experiment with different configurations, or even add multiple subwoofers to your system (see diagram).

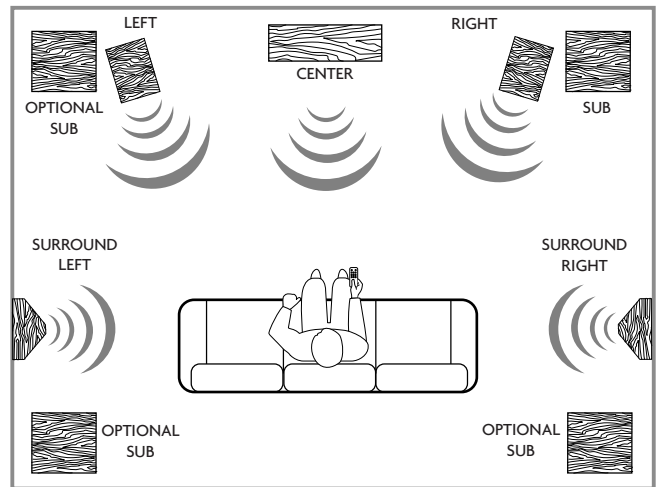

NOTE: When cleaning your subwoofer, avoid the use of abrasives, solvents, or harsh detergents. Windsor subwoofers have a long-lasting vinyl finish that should only require dusting or cleaning with a dry cloth. Gently use the brush attachment of your vacuum cleaner to remove any dust or particles from the surfaces of your subwoofer.

WARRANTY

Our 5 year warranty begins from purchase date of the item. (Receipt Date) Warranty registration must be completed at KLHAUDIO.com/warranty. Registration of the product must be completed within 120 days of purchase for warranty validation. Original receipt of purchase must be retained for proof of purchase. For warranty or service issues, please contact authorized KLH dealer. The warranty covers any production and/or material defects of the product. This warranty is non-transferable. The following is NOT COVERED by the warranty:

1. Accidents, misuse, poor maintenance, electrical overloads such as lightning or voltage.
2. Incorrect use of product.
3. Altered serial number.
4. Transportation costs for service call.
5. Purchase of KLH products from unauthorized reseller.

Replacement item cannot exceed the cost of the item under warranty. The supplier is responsible for only repair or replacement. KLH toll free number is 1-833-554-8326

SPECIFICATIONS

Stratton 10 Powered Subwoofer

Frequency response	29Hz-150Hz
Maximum Output	114dB.
Class "D" Digital Amplifier	200W rms/400W Dynamic Power
Components	10" Driver, Proprietary Blend of Treated Paper, Kevlar® and CSX
Enclosure Material	¾" MDF
Enclosure Type	Rear Slot Ported Bass Reflex
Inputs	Line Level/LFE Gold Plated RCA Jack
Dimensions	15.3" H x 17.72" W x 15.2" D (388mm H x 325mm W x 385mm D)
Weight	32 lbs. (14.55kg)
Finish	Carbon Black
Features	Volume, Lowpass, Phase, Trigger
Phase	Switchable 0-180 degrees
Power Rating	100-120V~/220-240V- 50Hz/60Hz

Stratton 12 Powered Subwoofer

Frequency response	25Hz-160Hz
Maximum Output	118dB.
Class "D" Digital Amplifier	200W rms/500W Dynamic Power
Components	12" Driver, Proprietary Blend of Treated Paper, Kevlar® and CSX
Enclosure Material	¾" MDF
Enclosure Type	Rear Slot Ported Bass Reflex
Inputs	Line Level/LFE Gold Plated RCA Jack
Dimensions	17.7" H x 15.4" W x 18.2" D (448mm H x 390mm W x 462mm D)
Weight	44 lbs. (20kg)
Finish	Carbon Black
Features	Volume, Lowpass, Phase, Trigger
Phase	Switchable 0-180 degrees
Power Rating	100-120V~/220-240V- 50Hz/60Hz

BACK PANEL



984 Logan Street, Suite 301
Noblesville, IN 46060
klhaudio.com